

Mr.Aqua INTERNAL FILTER INSTRUCTION

The english version instruction manuals should be provided, and the manuals should include following sentences :

- This appliance can be used by children aged from 8 years and above and persons with reduced physical, sensory or mental capabilities or lack of experience and knowledge if they have been given supervision or instruction concerning use of the appliance in a safe way and understand the hazards involved. Children shall not play with the appliance. Cleaning and user maintenance shall not be made by children without supervision.
- Children being supervised not to play with the appliance.
- The supply cord cannot be replaced. If the cord is damaged the appliance should be scrapped.
- Pollution of the liquid could occur due to leakage of lubricants.
- The pump is to be supplied through a residual current device(ECD) having a rated residual operating current not exceeding 30 MA.

Hereby we sincerely thank you for purchasing our product. To operate the product safely, please do read this manual carefully. Indoor use only.

Warning

- 1.Before using the product, please check if there is any damage on the power cord. If yes, please do not use the product.
- 2.To avoid default, please use the product under the regulated voltage and frequency.
3. Please do not plug or pull the power cord if your hands are wet.
- 4.When maintaining or moving the product or when there is any abnormal situation, please turn off the power first.
5. Please make sure the plug and socket are protected away from water.
Please keep the power cord to be "U" shape (see below picture) to avoid the water go inside the socket along the cord.
6. Please do not re-equip the product, to avoid any default.
7. If use in marine water, please periodically remove the crystal on the product or power cord in order to avoid electric leakage.



PRODUCT FEATURE

1. Less noise; less energy consumption.
2. Efficient cleaning, easy to replace the filter medium.
3. Several use method.
4. Suitable for fresh water & marine water.

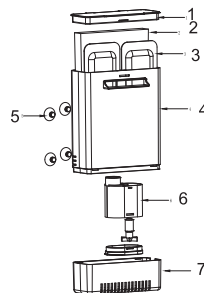

Accessories description

1. Filter top cover
2. Filter sponge
3. Carbon cartridge
4. Filter box body
5. Suction cup
6. Water pump
7. Filter bottom cover

Voltage	Power consumption	Output	Tank size
AC110V/60Hz	3.4W	180L/H	35L

Abnormality handling

Symptoms	Reason	Handling method
Not work properly	Not plugged	Plugged into power supply
	Pump head burned	Replace new pump
	Impeller was not installed properly or stucked by dirt	Reinstall properly or get out dirt
High noise	Impeller damaged or dirt or not installed in right place	Replace or reinstall properly or get out dirt
Small output	Filter medium dirty	Replace filter mediums